



Contact: Laura Hassell
Director of Production
Portland Opera
211 SE Caruthers Street
Portland, OR 97214
503-241-1407
lhassell@portlandopera.org



Table of Contents

Rental Information.....	2
Production Notes.....	5
Technical Notes.....	7
Costume Notes.....	8
Props List.....	9
Set Minis.....	11
Production Photos.....	13



Rental Information

Rental Cost Breakdown:

Sets/Props: \$25,000.00
 Costumes: \$15,000
Total Rental Cost: \$40,000.00

Surtitles available for an additional rental fee



Additional Costs:

Royalties & Rights	
Stage Director - Stephen Lawless	Right of First Refusal. Royalty of \$2,000 if not engaged.
Scenery Designer – Benoit Dugardyn	25% of rental fee (not less than \$5,000.00) Minimum of 5 days at USA daily rate
Costume Designer – Ingeborg Bernerth	25% of rental fee (not less than \$3,500.00) Minimum of 5 days at USA daily rate
Lighting Designer – Mark McCullough	Right of First Refusal. Royalty of \$2,000 if not engaged.
Choreographer –Matthew Ferraro	Royalty of \$500 if not engaged.
Deposits, Fees & Insurance	
Security Deposit (Refundable)	\$3,000.00
Rental Expense Fee	\$8,000.00
Insurance Valuation	\$160,000.00
Set Supervisor	
Supervisor Fees	Required for load-in and load-out \$450.00 per work day** / \$300.00 per travel day** / \$75.00 per diem**
Transportation & Housing	Responsibility of Renter
Shipping & Loading	
Trucking and Shipping	2- 53' air-ride trucks required.
Loading and Unloading Costs	\$4,500.00**
Notice for Loading	30 days

**Will be deducted from the Rental Expense Fee

Home Theater Information:

In Portland, the production was presented in the Keller Auditorium, which is described below:

Wall to wall width:	104'-2"	Depth of Apron:	6'-6"
Width within stagehouse:	104'-2"	Depth (p.l. to back wall):	42'
Wing width SR:	10'-8"	Depth (p.l. to last line):	41'-3"
Wing width SL:	13'-6"	Height of grid:	78'-6"
Number of line sets:	76	Height of proscenium:	30'
Load capacity of line sets:	1575 lbs	Width of proscenium:	60'
Offstage storage spaces: 19' X 100' - upstage 40' X 20' - south wing, offstage left			
Size & number of loading doors: 1 at 10' X 14'			

Technical Information:

Minimum Width:	71'	Minimum Depth:	36'
Total Line sets used:	35	Line sets used for Scenery:	7 (2 chandeliers)
Line sets used for Electrics:	7	Line sets used for masking:	12
Focus Tracks:	5		
Height of tallest drop:		Tripping of drops permitted:	NA
Furthest upstage flyer:	28' (Cyc) 32' (Bounce)	Weight of heaviest flyer:	225 lbs Red curtain traveler
Largest hard flying piece: NA			
Largest soft flying piece: (red curtain traveler)			

Groundcloths:

Set designed to include: Rake X Turntable Traps
Deck X Apron Overhead

Hardware available with rental: Assembly X Hanging X Specialty X

Stock items used: US escape scaffold – platform and stairs

Stock items available with rental:

Special storage considerations:

Weight of scenery for shipping: 10,000 lbs approximately

Rail shipment permitted: Yes

Notes:

Scenery requires 4 1-ton chain motors for assembly and run.
Rubble drop must be carefully planned to avoid performer injury
Rake is steep and may require additional non-slip treatment for dancers.

Properties Information:

Properties available with rental: Hand props X Furniture X
Groundcloths NA
Weapons No Set Props X
Specialty X

Specialty props used: Head of Jokanaan molded for specific performer (David Pittsinger).
Renting company should make arrangements for specific performer.
Blood not included.

Costume Information:

Costumes Designed By: Ingeborg Bernerth
Costumes Constructed By: Portland Opera Costume Shop 2013
Costume Supervisor: Frances Britt

Number of Costumes:

Principal Costumes:	Total: 17	Men: 13	Women: 3
Chorus Costumes:	Total: 0	Men: 0	Women: 0
Dancer Costumes:	Total: 6	Men: 0	Women: 6
Super Costumes:	Total: 1	Men: 1	Women: 0
Children Costumes:	Total: 0	Boys: 0	Girls: 0

Cast:

Number of Principals:	Men: 13	Women: 3
Number of Chorus:	Men: 0	Women: 0
Number of Dancers:	Men: 0	Women: 6
Number of Supers:	Men: 1	Women: 0
Number of Super Children:	Boys: 0	Girls: 0

Crew Numbers:

Department	Pack-in/Pack-out	Running
Wardrobe:	3	11
Make-up:		4 Principal, 4 Local

Wardrobe Head: Frances Britt
Number of Hours for Load-in: 2
Number of Hours Wardrobe Shop: 4 hours per performance

Description of special costumes: None

Accompanying accessories: Wigs: not Included
Headgear: Included
Legwear: Some Included
Jewelry: Included
Footwear: Some Included
Costume props: Included
Other Accessories: Included

Can costumes be washed: No
Dry cleaned: Yes
Are the costumes required to be returned cleaned? Yes X No _____
If no, who pays for laundering? Company _____ Renter X
Cleaning (approx): \$ 1000.00**

**Will be deducted from the Rental Expense Fee

History of Previous Usage:

Portland Opera November, 2013
Virginia Opera: February, 2015

PLEASE NOTE: All production materials must be returned within thirty (30) days of the final performance. A payment of fifty dollars (\$50.00) will be required for materials not returned.

Production Notes

Artistic Staff:

Stage Director:	Stephen Lawless
Conductor:	George Manahan
Assistant Conductor:	Nicolas Fox
Choreographer:	Matthew Ferraro
Assistant Stage Director:	Matthew Ferraro

Designers:

Set Designer:	Benoit Dugardyn	Assistant Set Designer:	None
Costume Designer:	Ingeborg Bernerth	Assistant Costume Designer:	None
Lighting Designer:	Mark McCullough	Assistant Lighting Designer:	Kimberly Scott
Wig & Make-up Designer:	Pat Polen		

Cast:

Number of Principals:	Men: 13	Women: 3
Number of Chorus:	Men: 0	Women: 0
Number of Supers:	Men: 1	Women: 0
Number of Dancers:	Men: 0	Women: 6*

*As possible, female dancers should be same height and build as Salome.

Staff:

Technical Dir:	Kellie Knight	Asst. Technical Dir:	Liz Bonnett
Production Carpenter:	Rick Schreiner	Wigs/Make-up Sup:	Pat Polen
Costume Supervisor:	Frances Britt	Property Master:	Cindy Felice
Production Electrician:	Mark LaPierre	Accompanists:	Jay Rozendaal
Stage Manager:	Jennifer Hammontree		
Assistant Stage Mgrs:	Carla E. Jimenez		
	Jon Wangsgard		

Schedule:

Date of First Principal Rehearsal:	10/7/13		
Total Number of Rehearsal Hours:	Room Reh: 60	In Theatre: 18	
Date of first Dancer Rehearsal:	10/11/13		
Total Number of Dancer Rehearsal Hours:	Room Reh: 24.5	In Theatre: 13.5	
Date of first Super Rehearsal:	10/7/13	Rehearsed as a principal	
Date of First Orch. Rehearsal:	10/19/2013	Total Hours of Rehearsal:	17.5
Orchestra Overtime:	Rehearsal: 0	Performance: 0	
Dates of Piano Tech Rehearsals:	10/25/13, 10/26/13	4 hours each	
Date of Piano Dress Rehearsal:	10/27/13	4 hours	
Dates of Orchestra Dress Rehearsals:	10/28, 10/30/13	3 hours each	
Date of Load-in:	10/22/2013	Date of Load-out:	11/10/2013

Running Times:

Total Running Time of Show: 1 hour 45 minutes

Number of Intermissions: NONE

Music:

Surtitles Written By: Clare Burovac
Surtitles Cued By: Jessica Crawford
Royalty Agreement With: N/A
Publisher of Orchestration: Kalmus
Publisher of Piano Reduction: Boosey & Hawkes
Orchestra:

Number of Musicians:	73				
Breakdown:	Strings: 40	Winds: 13	Brass: 13	Harp: 1	
	Perc.: 6	Keyboard: 0			

Special Musical Requirements: none
Musical Instrument Rental: none
Number of Backstage Conductors: 1
Harpichordist: None
Number of Orchestra Rehearsal Hours: Readings: 9 Sitz: 2.5 Dress: 6
Breakdown of Chorus: S: 2* A: 3* T: 8 B: 8
*3 Women in Supporting roles (Edith, Kate, Isabel) also sing all chorus parts for a total of 8 women.
Additional Chorus Requirements: None
Total Hours of Score Preparation: approximately 100
Cuts: None

Misc:

Lost/Misplaced Items: None

Broken Items: None

Crossover Required: Yes

Special Problem Descriptions: There is a great deal of blood which requires careful clean up on costumes, props and scenery.

Technical Notes

Crew Numbers:

Department	Load-in/ load-out	Running
Carpenters	11 deck 4 fly 3 rig	2 deck 2 fly
Electrics	14	1 board op 1 deck 2 spots
Props	4	4

Scenery Constructed by: Seattle Opera Shop
 Number of Trucks: 2 Size of Trucks: 53'' air ride
 Production Carpenter: Rick Schreiner
 Total Hours for Load-in: 8
 Total Hours for Load-out: 4
 Props Constructed by: Portland Opera Prop Shop
 Prop Master: Cindy Felice

Scenery/Prop items not included with show package: 4 chain motors for scenery assembly,
 scaffold and escape stairs for UL escape door,
 head of Jokanaan,
 blood jam
 Extra debris for debris drop may be needed, not included

Specialty equipment included: traveler track with kabuki drop rig for red curtain

Lighting/Sound:

Special Lighting Equipment: None
 Projection Equipment: None
 Production Electrician: Mark LaPierre
 Number of Hours to Hang: 6
 Number of Hours to Focus: 8
 Number of Hours to Cue: 12
 Sound Requirements: None
 Head of Sound: Michael Johnson
 Equipment/Effects Not Included with Show: none

Costume Notes

Costumes/Make-up:

Costumes Constructed By: Portland Opera Costume Shop 2013
 Costume Supervisor: Frances Britt
 Wigs and Make-up by: Theatrical Hairgoods

Number of Costumes:

Principal Costumes:	Total: 17	Men: 13	Women: 3
Chorus Costumes:	Total: 0	Men: 0	Women: 0
Dancer Costumes:	Total: 6	Men: 0	Women: 6
Super Costumes:	Total: 1	Men: 1	Women: 0
Children Costumes:	Total: 0	Boys: 0	Girls: 0
Banda Costumes:	Total: 0	Men: 0	Women: 0

Crew Numbers:

Department	Pack-in/Pack-out	Running
Wardrobe:	2	3
Make-up:		5 Principal, 2 Local

Wardrobe Head: Frances Britt
 Number of Hours for Load-in: 2
 Number of Hours Wardrobe Shop: 4 hours per performance

 Number of Services for Wig Crew: 7

 Number of Principal Wigs: 3 wigs, 1 fall
 Number of Principal facial pieces: 0
 Number of Non-Principal Wigs & facial pieces: 0

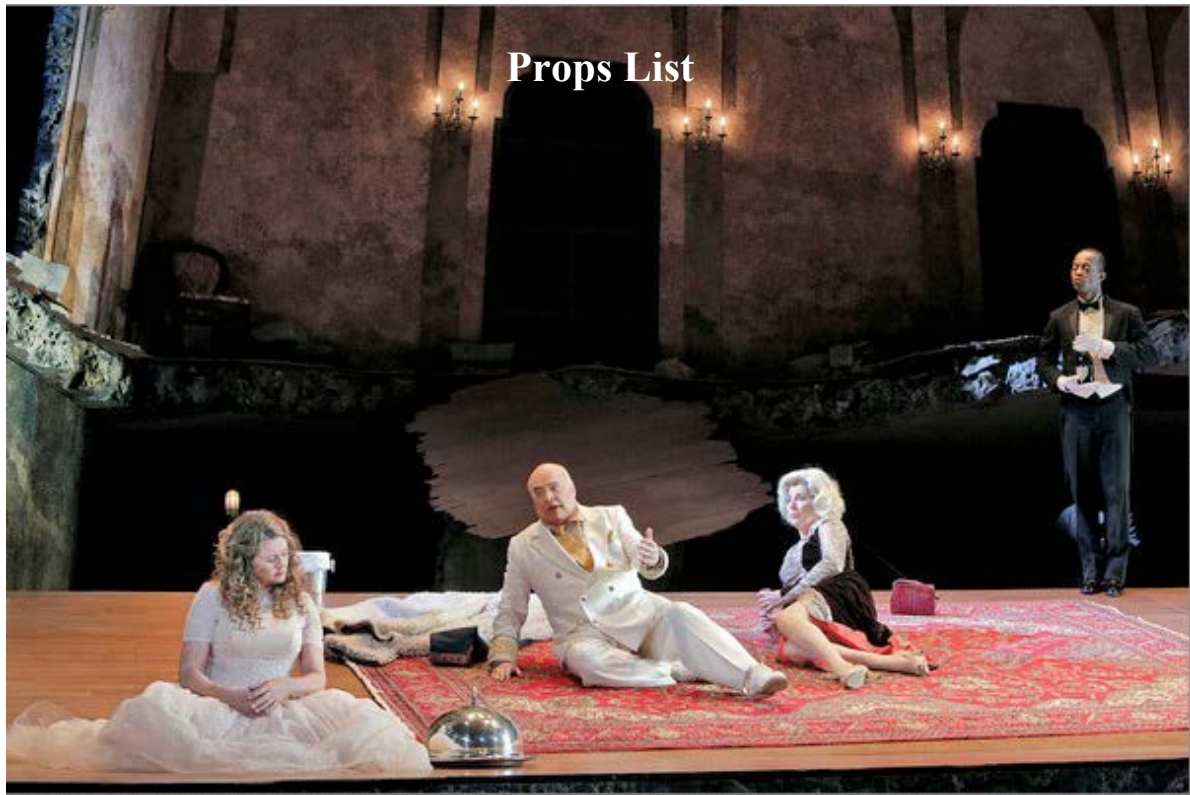

#	ITEM	PRESET	CHARACTER	EXIT	NOTES
1	Cigarette Pack w/	CS2	Cappadocian	SL4	CONSUMABLE
10	Puff Cigarettes &	CS2	Cappadocian	SL4	CONSUMABLE
1	eCigarette	CS2	Cappadocian	SL4	PRACTICAL CONSUMABLE
1	Cleaning Cloth	CS2	Cappadocian	SL4	PRACTICAL
1	Knife w/ Sheath	SL4	Narraboth	OnS	REPEAT COSTUMES
5	Prayer Books	SR1 SR1 SL4 SR1 SL4	1 st Jew 2 nd Jew 3 rd Jew 4 th Jew 5 th Jew	SR1 SR1 SL4 SR1 SL4	Contemporary & Orthodox REPEAT
+	Sand	Cistern	Jokanaan	OnS	CONSUMABLE
+	Blood	SL4	Narraboth	OnS	CONSUMABLE For Knife, Sword & Head
1	Bulb Syringe w/	SL4	Narraboth	SL4	PRACTICAL
+	Blood	SL4	Narraboth	SL4	CONSUMABLE
1	Cigarette Case w/	Up CS5	Executioner	MSL	Gold Metal
5	Puff Cigarettes &	Up CS5	Herodias	MSL	CONSUMABLE
1	eCigarette	Up CS5	Herodias	MSL	PRACTICAL

					CONSUMABLE
1	eCigarette	Up CS5	Herodias Page	SL4	PRACTICAL CONSUMABLE
1 +	Wine Glass w/ Water	Up CS5	Herodias Page	SL4	PRACTICAL CONSUMABLE
1	Purse w/ Compact & Bracelet	Up CS5 Up CS5 Up CS5	Herodias Herodias Herodias	OnS OnS OnS	
1	Ashtray	SR1	Page	SL4	Clear Glass
1 +	Champagne Bucket w/ Fake Ice, Waiter Towel & Champagne Bottle w/ Water	CS2 CS2 CS2 CS2 CS2	Executioner Executioner Executioner Herod Executioner Executioner Herodias	CS2 CS2 CS2 CS2 CS2	PRACTICAL CONSUMABLE
1	Champagne Glass	CS2	Executioner Herodias	OnS	PRACTICAL CONSUMABLE Breakaway & Taped
1 +	Tray w/ Fake Fruit, Bunches of Grapes, Orange & Cloche (Lid)	CS2 CS2 CS2 CS2	Cappadocian Executioner Cappadocian Cappadocian Herod Cappadocian Executioner	CS2 CS2 CS2 SR1 CS2	Large Silver Platter, Oval CONSUMABLE CONSUMABLE Part Pre-Peeled Silver, Large Dome Plate Cover, With Handle REPEAT
1	Ziploc Bag w/ Damp Towel	CS2 CS2	1st Jew 1st Jew	SL4 SL4	PRACTICAL
1	Long Rolled Scroll w/ Wooden Handles	SR1	2nd Jew	CS2	PRACTICAL Contemporary & Orthodox
2	Napkins	Up CS5 Up CS5	1st Nazarene 2nd Nazarene	CS5 OnS	
1	Champagne Glass w/ Water	Up CS5	Page Herodias	SL4	PRACTICAL CONSUMABLE
1	Chair	CS2	Executioner Salome 2nd Jew	SR1	
1	Empty Tray w/ Cloche (Lid)	CS2 CS2	Executioner Salome Executioner Salome	MSL MSL	Fruit Tray Duplicate Silver, Large Dome Plate Cover, With Handle REPEAT

1	Waiter Towel &	SL4	Executioner Herod	SL4	PRACTICAL
1	Champagne Bottle w/	SL4	Executioner Herod	SL4	PRACTICAL
+	Water	SL4	Executioner Herod	SL4	CONSUMABLE
1	Champagne Glass w/ Water	SL4	Executioner	SL4	PRACTICAL CONSUMABLE
3	White Peacock Feathers	SL4	Executioner Herod	OnS	
1	Champagne Glass w/ Water	SL4	Cappadocian Herodias Salome	SL4	PRACTICAL CONSUMABLE
1	Sword	CS2	2nd Soldier	OnS	REPEAT
1	Bloody Tray w/	Cistern	Executioner Salome	OnS	Fruit Tray Duplicate
1	Jokanaan Head w/	Cistern	Executioner Salome	OnS	WIGS / HAIR Cast of Singer
+	Blood	Cistern	Executioner Salome	OnS	CONSUMABLE

**** Items Not included in rental.**

Set Minis

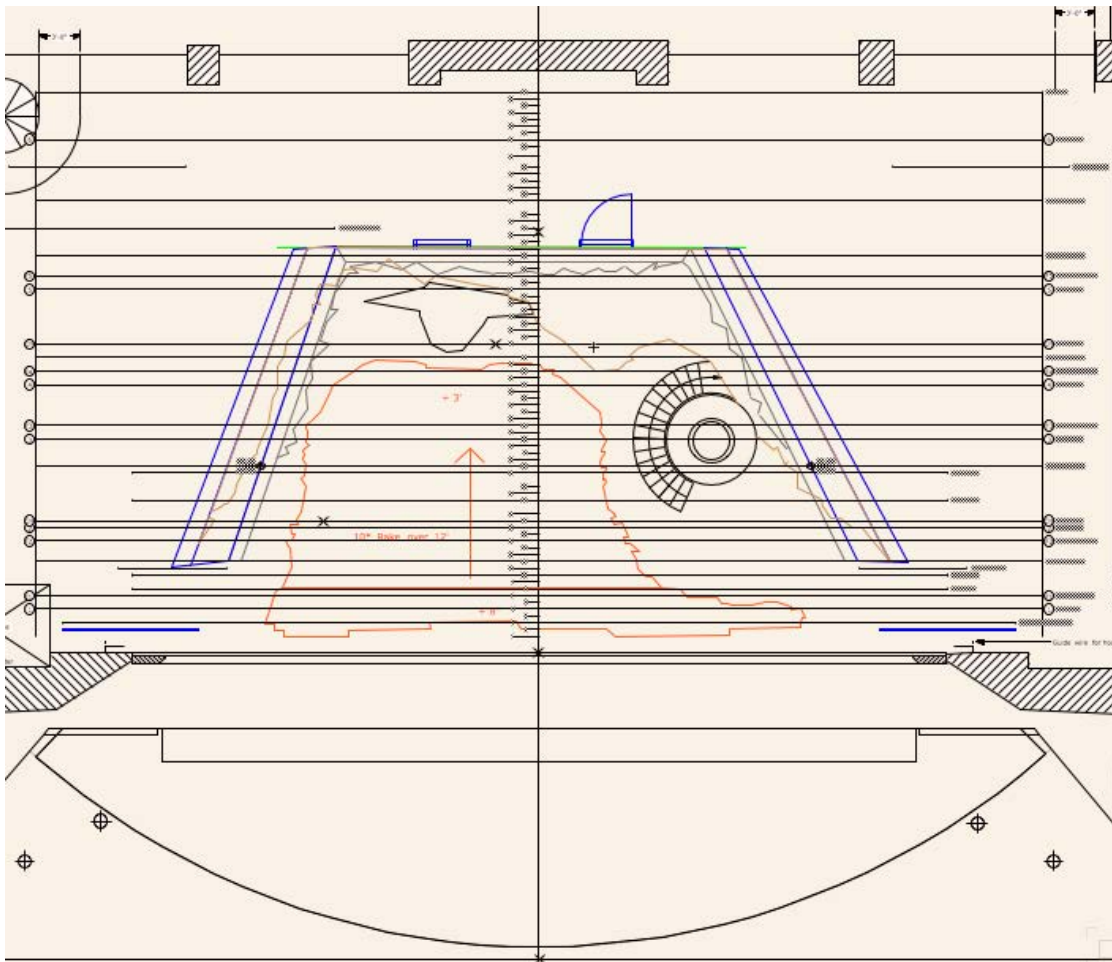
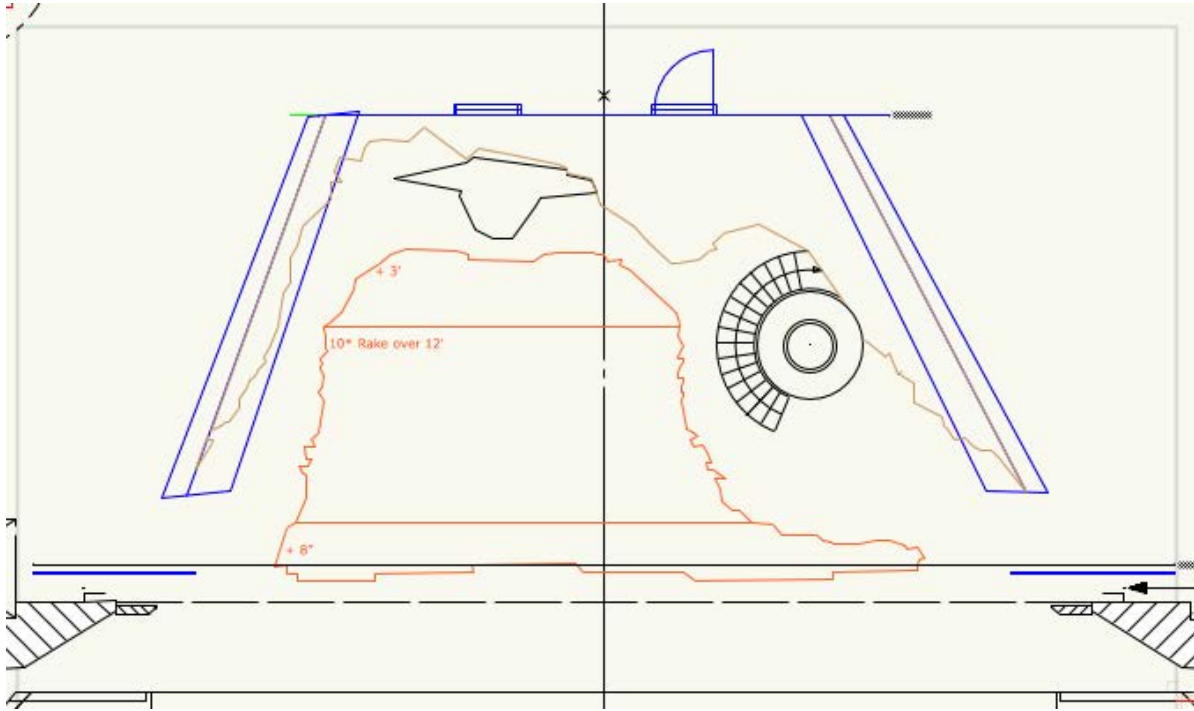

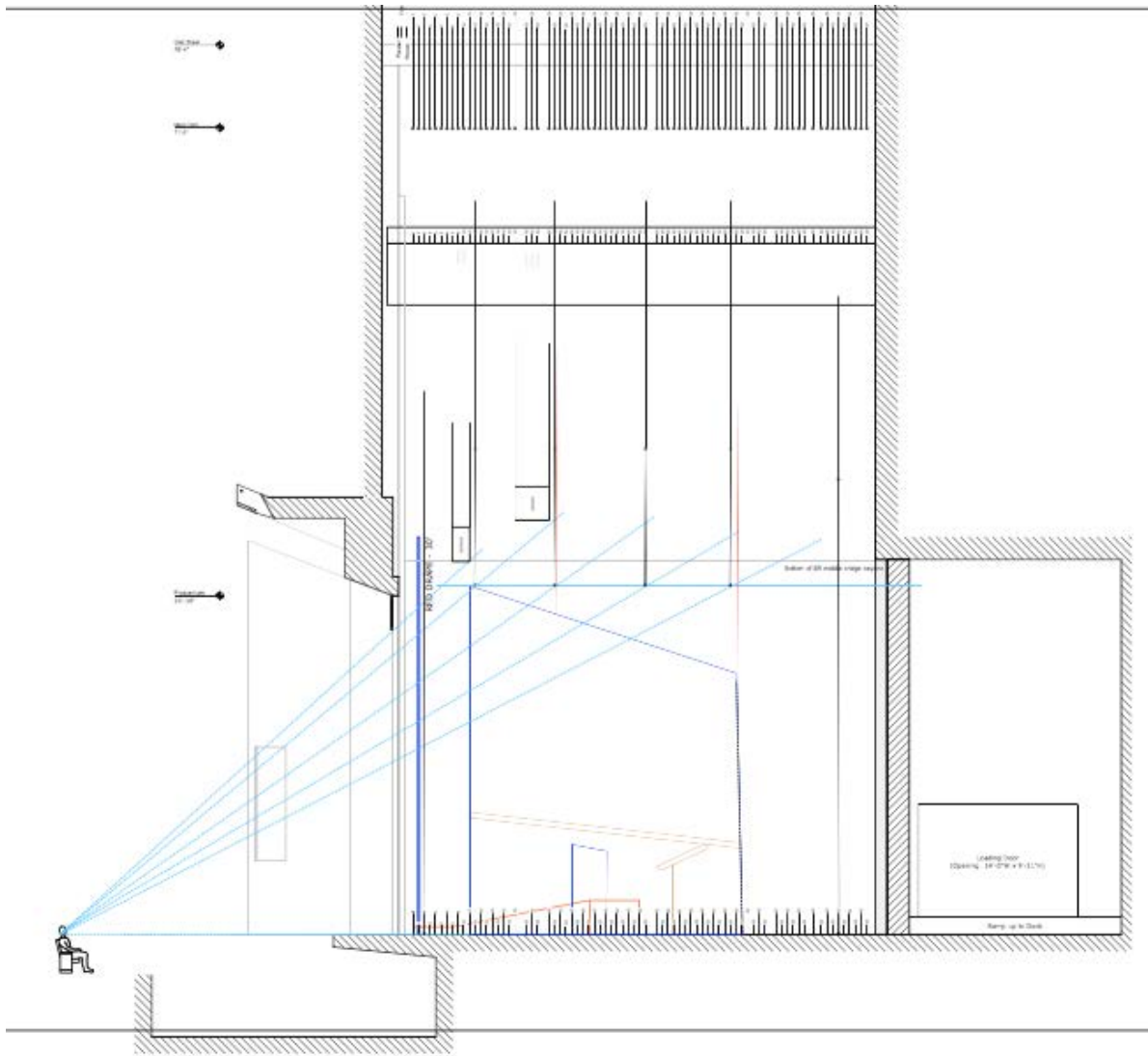

Hang Schedule

DIM	LINE	DESCRIPTION	TRIM	WEIGHT	NOTES
0'-0"		PL			
0'-3"		Fire curtain			
0'-6"		Back of Smoke Pocket			
0'-9"		Knife (Red Satin)			
1'-3"	1	Keller Portal Border	26'-0"		11'x70' on CL
1'-9"	2	POA Hard Legs			Hang 25' R&L of CL
2'-3"	3	Red Curtain Traveler	Deck	~225	POA Red Kabuki Drop (33 lbs)/traveler. + 2- 35' tag lines
2'-9"	4				Movers + Tag

15'-3"	27				Movers
15'-9"	28	LX 3	34'3"		
16'-3"	29				
16'-9"	30	Focus Track #3		~370	Starting SL - 62' Run (-12')
17'-3"	31	#2 Chandelier			1'6" SL of CL, On deck/flies,(in picture) Tagline SR.
17'-9"	32				
18'-3"	33	Audio Monitors #2			8'-0" R&L of CL
18'-9"	34				
19'-3"	35	SR Leg 1	deck		Keller 35'x21' Blk. Leg, 22' SR of CL
19'-9"	36	LX 4	36'-0"		Movers
20'-3"	37				
20'-9"	38	Focus Track #4		~370	Starting SL - 62' Run (-12')
21'-3"	39				
21'-9"	40	#3 Border	30'8"		Keller 12'x74' Black Border
22'-9"	41				
23'-3"	42				
23'-9"	43	#2 SkyCam			9'-0" SL of CL
24'-3"	44				
24'-9"	45	SR Leg 2	deck		Keller 35'x21' Blk. Leg, 20' SR of CL
25'-3"	46				
25'-9"	47				
26'-3"	48				Movers
26'-9"	49	LX 5	35'6"		
27'-3"	50				
27'-9"	51	Focus Track #5		~345	Starting SL - 55' Run (-7', 12')
28'-3"	52				
28'-9"	53				
29'-3"	54	#4 Border	30'8"		Keller 12'x74'

B		H		Full run @ 40' SL
C		J		
D		K		
E		L		
F		M		

Production Photos



Open Stage



Salome Seated



Jokanaan Released



Jokanaan Duet

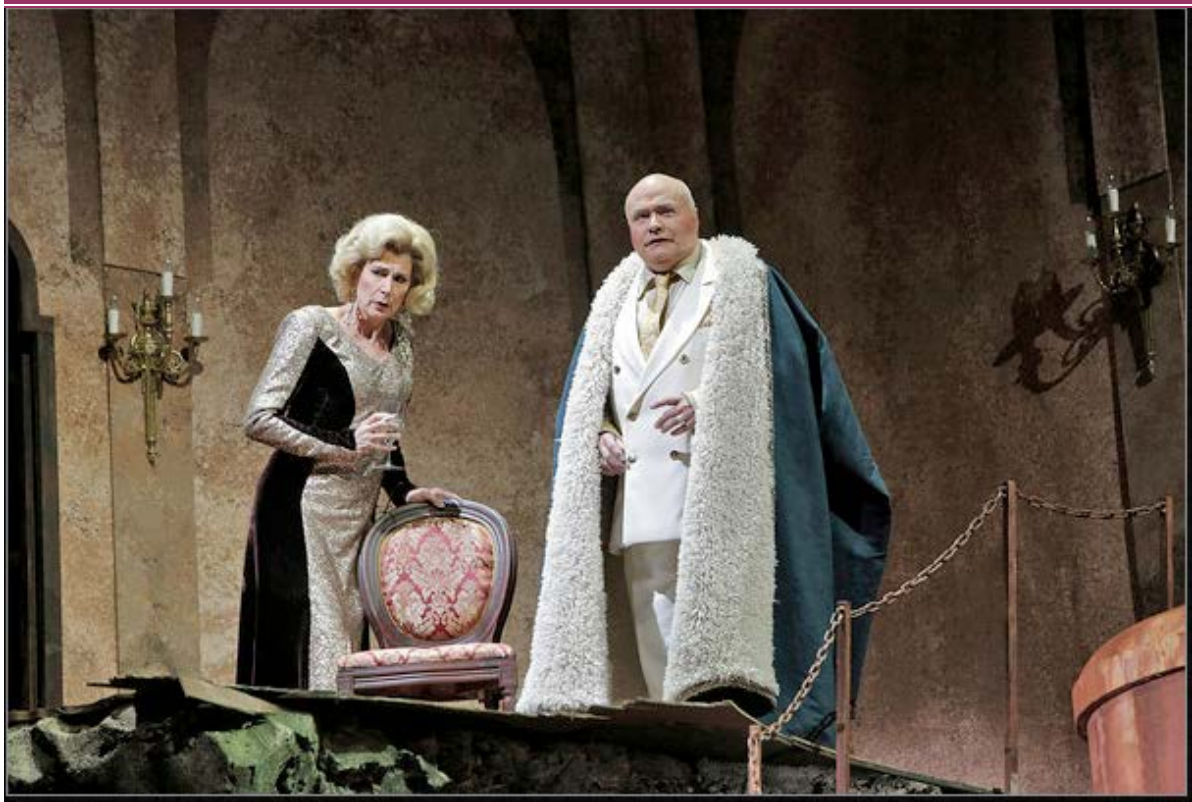

Happy Herods



Picnic

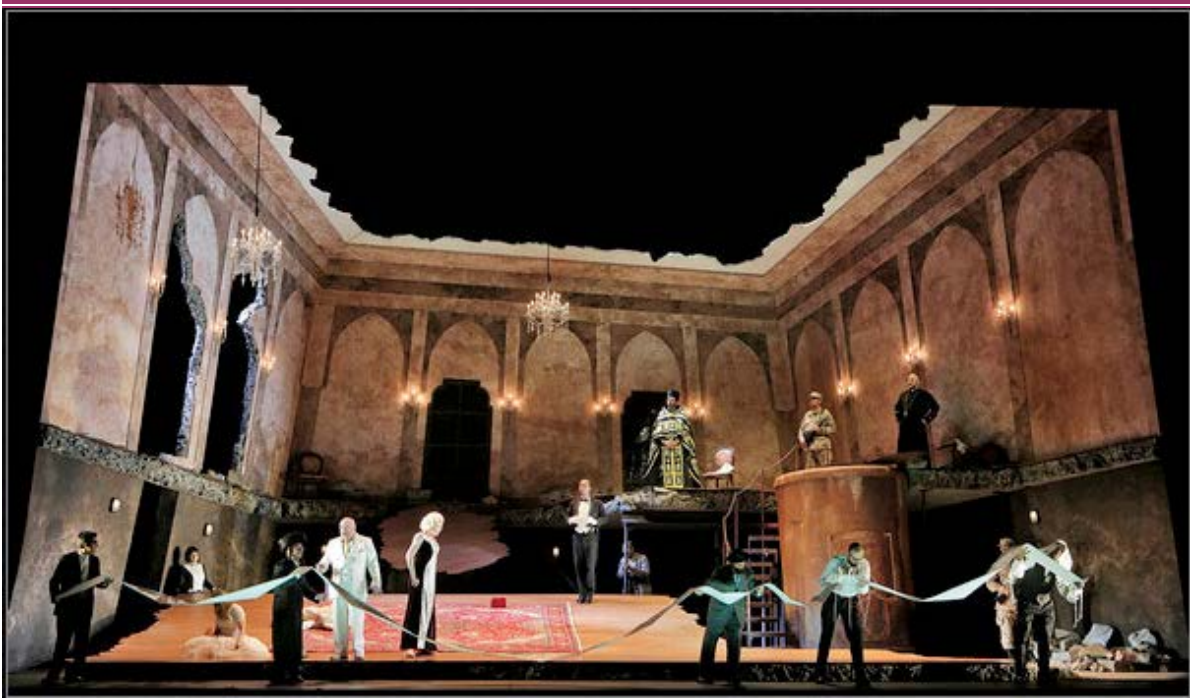

Jews



Collapsed



7 Viels



Red Curtain Falling



Impending Doom



Beheading



Head Presentation



Head Hug



Rubble Drop in Red (Later changed to white)